

Tritax Symmetry (Hinckley) Limited

HINCKLEY NATIONAL RAIL FREIGHT INTERCHANGE

The Hinckley National Rail Freight Interchange Development Consent Order

Project reference TR050007

Appendix 8 - HGV Route Management Plan and Strategy (Appendices)

Document Reference: 17.4F

Revision: 15

December 2024

Planning Act 2008

The Infrastructure Planning (Applications: Prescribed Forms and Procedure) Regulations
2009 Regulation 5(2)(q)

The Infrastructure Planning (Environmental Impact Assessment) Regulations 2017
Regulation 14

Appendix 1 – ANPR Camera Position Plans

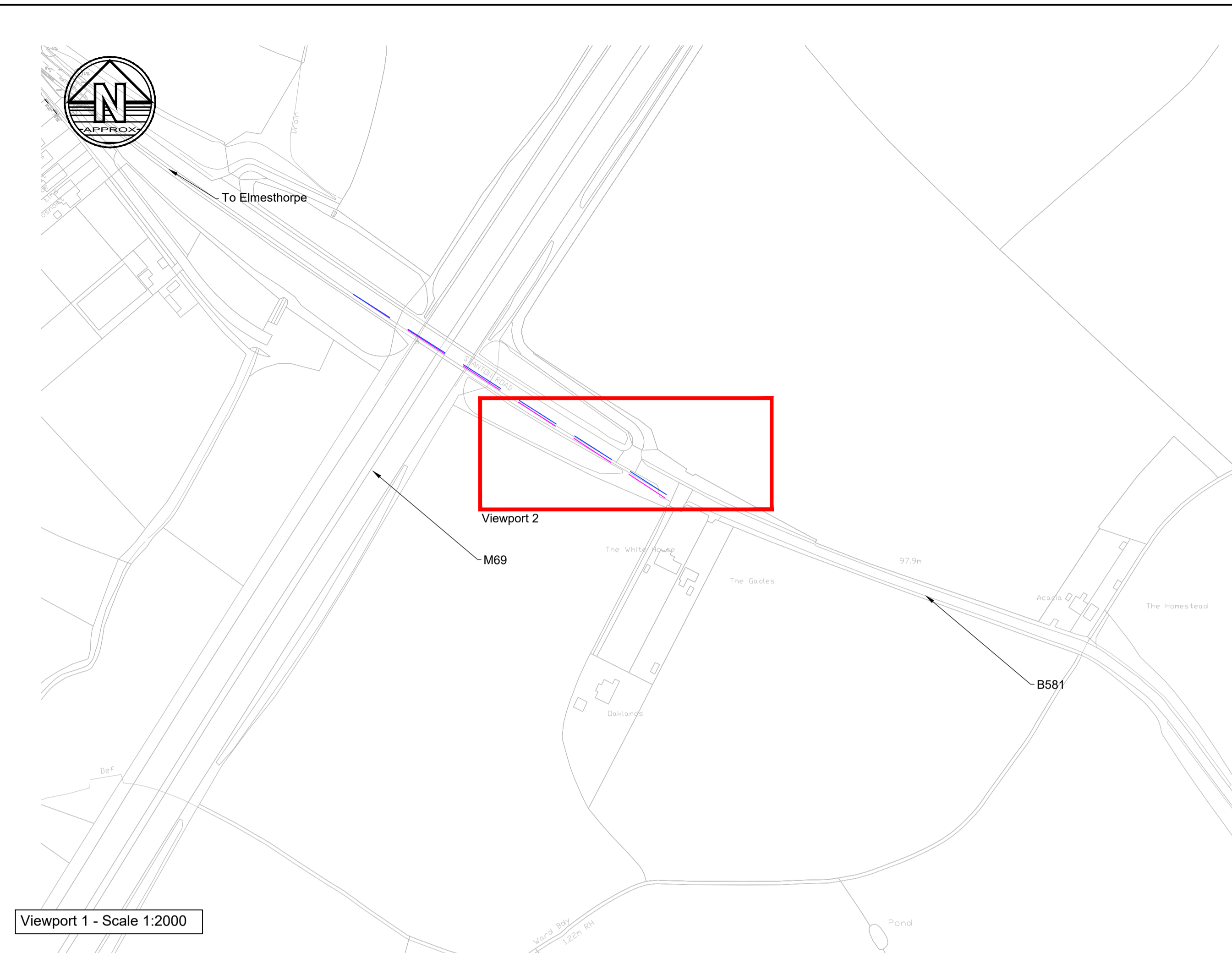

Viewport 1 - Scale 1:2000



Streetview Image of Approximate Location

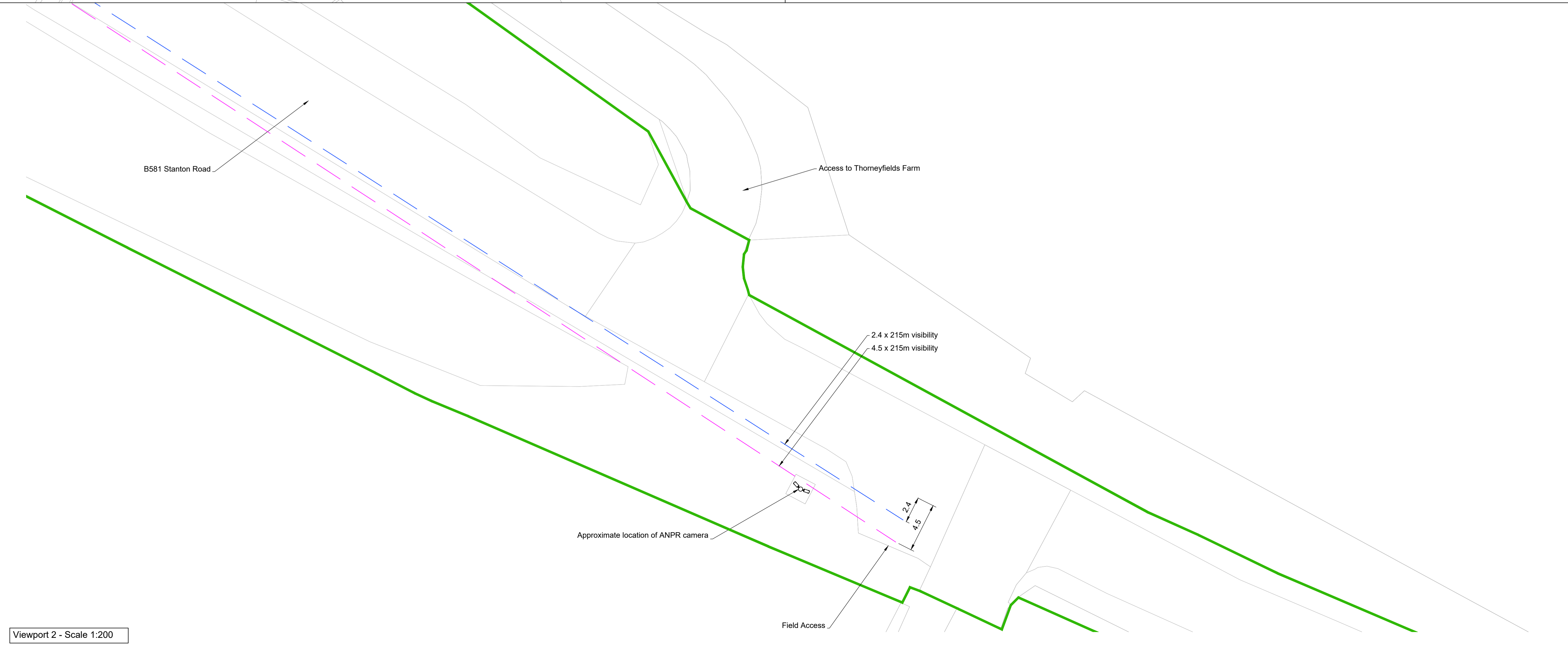

Viewport 2 - Scale 1:200

- Notes**
1. Do not scale this drawing. All dimensions must be checked/ verified on site. If in doubt ask.
 2. This drawing is to be read in conjunction with all relevant architects, engineers and specialists drawings and specifications.
 3. All dimensions in millimetres unless noted otherwise. All levels in metres unless noted otherwise.
 4. Any discrepancies noted on site are to be reported to the engineer immediately.
 5. ANPR locations shown indicatively. Subject to detailed design, survey and approval by relevant highway authorities.

Legend

- LCC Highway Boundary

P03	27.02.24	Visibility Splays Added	SC	SD
P02	20.02.24	Drawing Number Update	SC	AP
P01	31.01.24	Preliminary Issue	SC	AP
Rev	Date	Details of issue / revision	Drw	Rev

Issues & Revisions

BWB
A CAF GROUP COMPANY

- Birmingham | 0121 233 3322
- Leeds | 0113 233 8000
- London | 020 7407 3879
- Manchester | 0161 233 4260
- Nottingham | 0115 924 1100

www.bwbconsulting.com

Client

TRITAX SYMMETRY
A TRITAX BIG BOX COMPANY

Project Title

**HINCKLEY NATIONAL RAIL
FREIGHT INTERCHANGE**

Drawing Title

**HGV ROUTING
STRATEGY
ANPR CAMERA 1
LOCATION**

Drawn:	S. Carter	Reviewed:	A. Passmore
BWB Ref:	NTT2814	Date:	20.02.24
Scale@A1:	As Shown	Status:	S2
PRELIMINARY			
Project - Originator - Zone - Level - Type - Role - Number	Status	Rev	
HRF-BWB-HSN-01-DR-CH-1250	S2	P03	

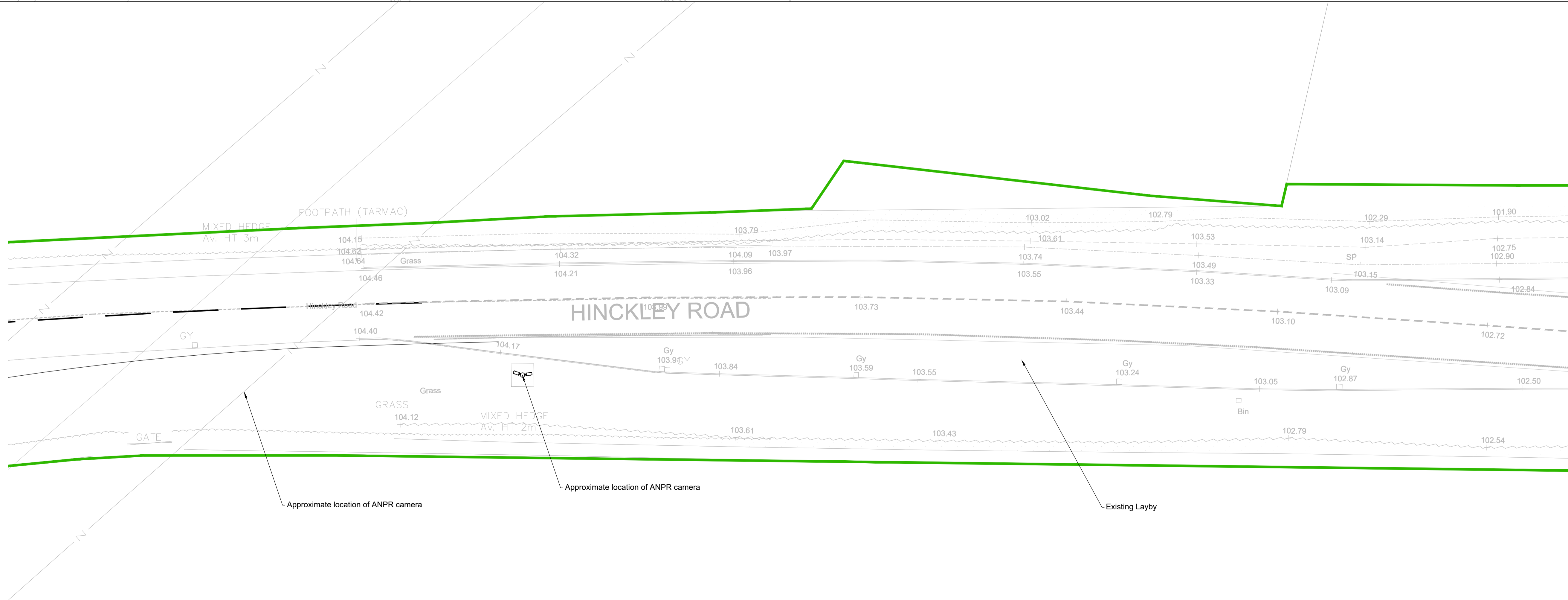
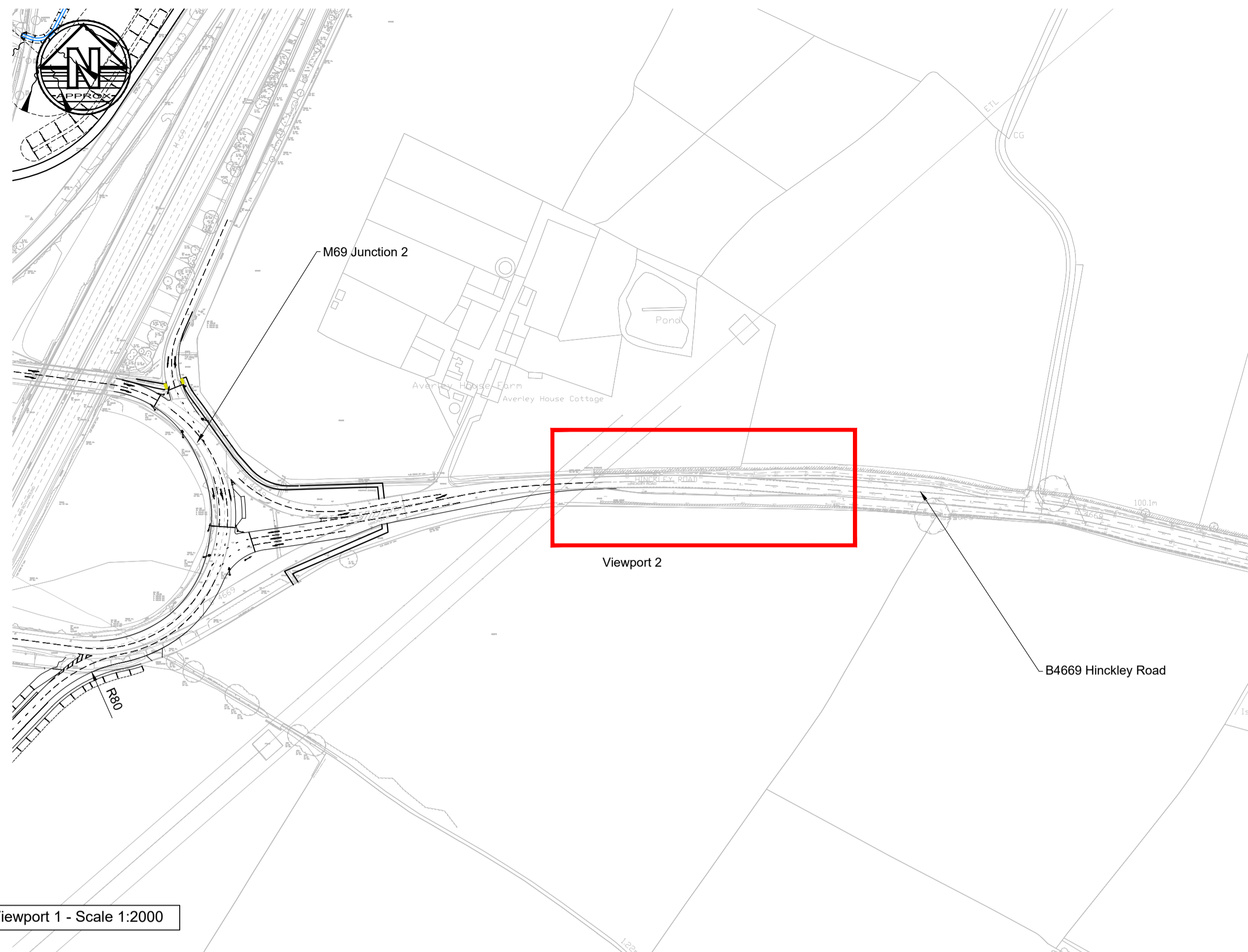

- Notes**
- Do not scale this drawing. All dimensions must be checked/ verified on site. If in doubt ask.
 - This drawing is to be read in conjunction with all relevant architects, engineers and specialists drawings and specifications.
 - All dimensions in millimetres unless noted otherwise. All levels in metres unless noted otherwise.
 - Any discrepancies noted on site are to be reported to the engineer immediately.
 - ANPR locations shown indicatively. Subject to detailed design, survey and approval by relevant highway authorities.

Legend

— LCC Highway Boundary

P02	20.02.24	Drawing number Update	SC	AP
P01	31.01.24	Preliminary Issue	SC	AP
Rev	Date	Details of issue / revision	Drw	Rev

Issues & Revisions

BWB
A CAF GROUP COMPANY

- Birmingham | 0121 233 3322
- Leeds | 0113 233 8000
- London | 020 7407 3879
- Manchester | 0161 233 4260
- Nottingham | 0115 924 1100

www.bwbconsulting.com

Client

TRITAX SYMMETRY
A TRITAX BIG BOX COMPANY

Project Title

HINCKLEY NATIONAL RAIL FREIGHT INTERCHANGE

Drawing Title

HGV ROUTEING STRATEGY ANPR CAMERA 2 LOCATION

Drawn:	S. Carter	Reviewed:	A. Passmore
BWB Ref:	NTT2814	Date:	20.02.24
Scale@A1:	As Shown		

Drawing Status

PRELIMINARY

Project - Originator - Zone - Level - Type - Role - Number	Status	Rev
HRF-BWB-HSN-02-DR-CH-1250	S2	P02

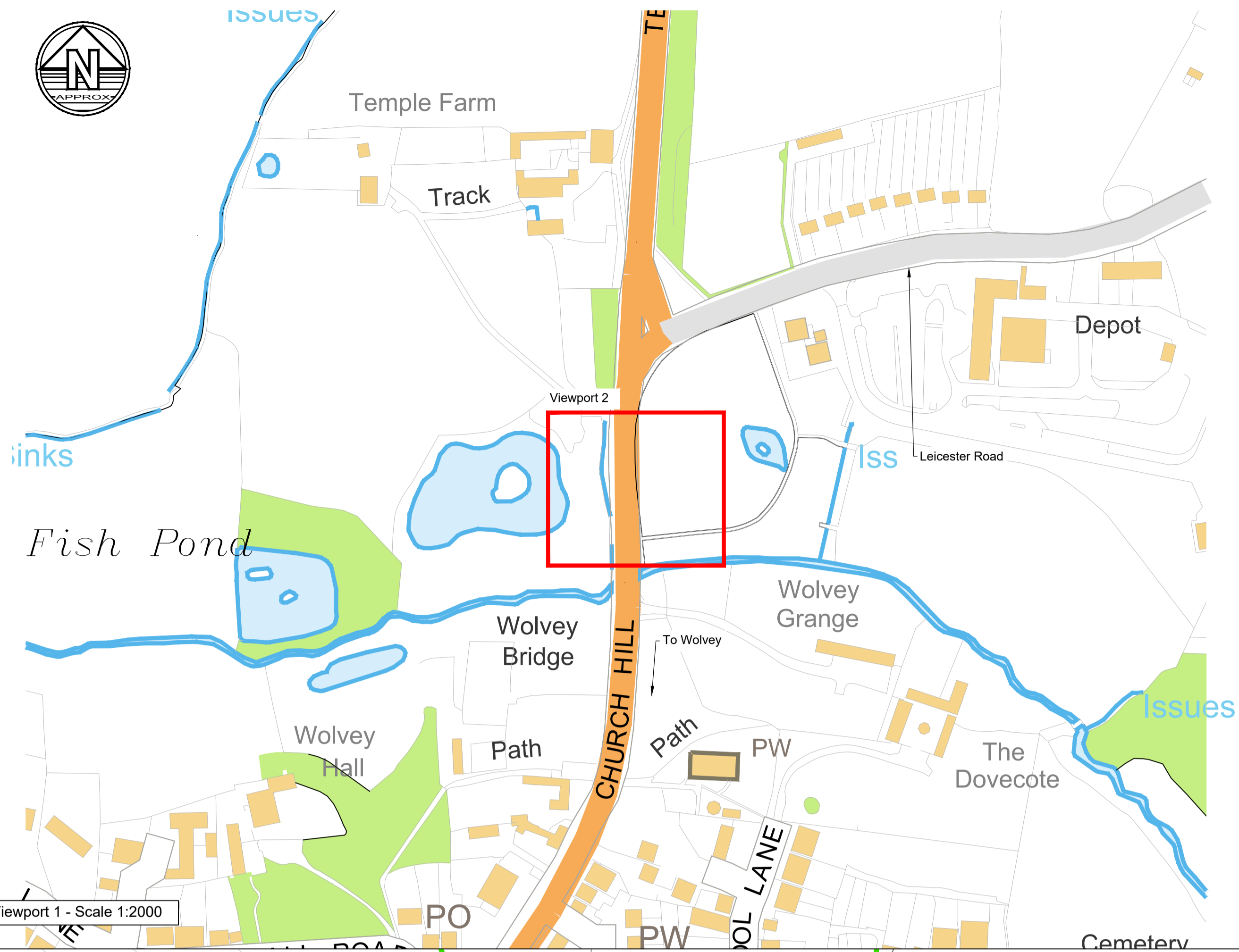

Streetview Image of Approximate Location



Notes

1. Do not scale this drawing. All dimensions must be checked/ verified on site. If in doubt ask.
2. This drawing is to be read in conjunction with all relevant architects, engineers and specialists drawings and specifications.
3. All dimensions in millimetres unless noted otherwise. All levels in metres unless noted otherwise.
4. Any discrepancies noted on site are to be reported to the engineer immediately.
5. ANPR locations shown indicatively. Subject to detailed design, survey and approval by relevant highway authorities.

Legend

Indicative WCC Highway Boundary

P02	20.02.24	Relocated Camera	SC	AP
P01	31.01.24	Preliminary Issue	SC	AP
Rev	Date	Details of issue / revision	Drw	Rev

Issues & Revisions

BWB
A CAF GROUP COMPANY

- Birmingham | 0121 233 3322
- Leeds | 0113 233 8000
- London | 020 7407 3879
- Manchester | 0161 233 4260
- Nottingham | 0115 924 1100

www.bwbconsulting.com

Client

TRITAX SYMMETRY
A TRITAX BIG BOX COMPANY

Project Title

**HINCKLEY NATIONAL RAIL
FREIGHT INTERCHANGE**

Drawing Title

**HGV ROUTING
STRATEGY
ANPR CAMERA 3
LOCATION**

Drawn:	S. Carter	Reviewed:	A. Passmore
--------	-----------	-----------	-------------

BWB Ref:	NTT2814	Date:	20.02.24	Scale@A1:	As Shown
----------	---------	-------	----------	-----------	----------

Drawing Status

PRELIMINARY

Project - Originator - Zone - Level - Type - Role - Number	Status	Rev
HRF-BWB-HSN-03-DR-CH-1250	S2	P02

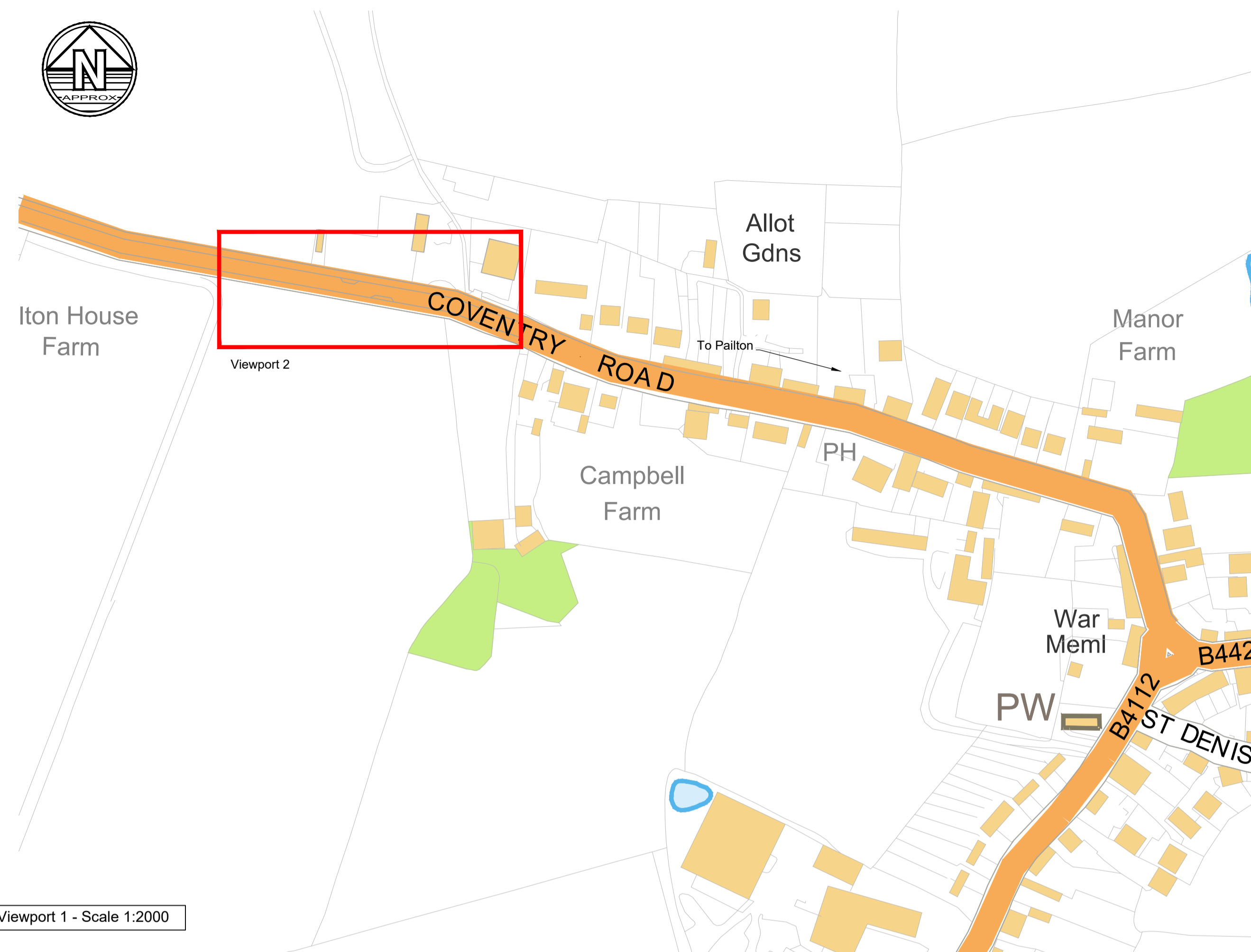

Viewport 1 - Scale 1:2000



Streetview Image of Approximate Location



Viewport 2 - Scale 1:200

Notes

1. Do not scale this drawing. All dimensions must be checked/ verified on site. If in doubt ask.
2. This drawing is to be read in conjunction with all relevant architects, engineers and specialists drawings and specifications.
3. All dimensions in millimetres unless noted otherwise. All levels in metres unless noted otherwise.
4. Any discrepancies noted on site are to be reported to the engineer immediately.
5. ANPR locations shown indicatively. Subject to detailed design, survey and approval by relevant highway authorities.

Legend

Indicative WCC Highway Boundary

P01	31.01.24	Preliminary Issue	SC	AP
Rev	Date	Details of issue / revision	Drw	Rev

Issues & Revisions

BWB
A CAF GROUP COMPANY

- Birmingham | 0121 233 3322
- Leeds | 0113 233 8000
- London | 020 7407 3879
- Manchester | 0161 233 4260
- Nottingham | 0115 924 1100

www.bwbconsulting.com

Client

TRITAX SYMMETRY
A TRITAX BIG BOX COMPANY

Project Title

HINCKLEY NATIONAL RAIL FREIGHT INTERCHANGE

Drawing Title

HGV ROUTEING STRATEGY ANPR CAMERA 4 LOCATION

Drawn:	S. Carter	Reviewed:	A. Passmore
BWB Ref:	NTT2814	Date:	31.01.24
Scale@A1:	As Shown		

Drawing Status

PRELIMINARY

Project - Originator - Zone - Level - Type - Role - Number	Status	Rev
HRF-BWB-HSN-04-DR-CH-1250	S2	P01

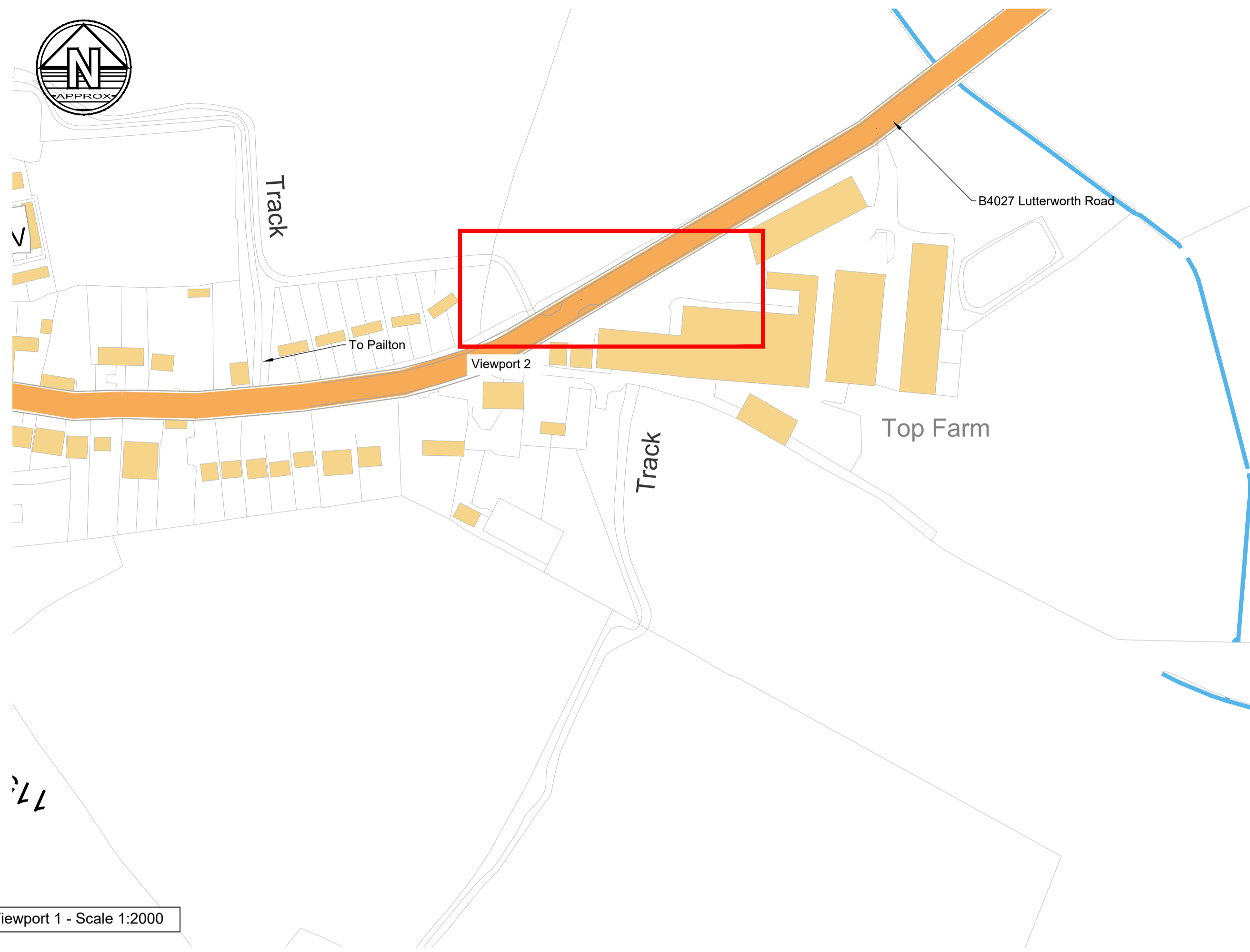

Viewpoint 1 - Scale 1:2000



Streetview Image of Approximate Location



Viewpoint 2 - Scale 1:200

Notes

1. Do not scale this drawing. All dimensions must be checked/ verified on site. If in doubt ask.
2. This drawing is to be read in conjunction with all relevant architects, engineers and specialists drawings and specifications.
3. All dimensions in millimetres unless noted otherwise. All levels in metres unless noted otherwise.
4. Any discrepancies noted on site are to be reported to the engineer immediately.
5. ANPR locations shown indicatively. Subject to detailed design, survey and approval by relevant highway authorities.

Legend

Indicative WCC Highway Boundary

P01	31.01.24	Preliminary Issue	SC	AP
Rev	Date	Details of issue / revision	Drw	Rev

Issues & Revisions

BWB
A CAF GROUP COMPANY

- Birmingham | 0121 233 3322
- Leeds | 0113 233 8000
- London | 020 7407 3879
- Manchester | 0161 233 4260
- Nottingham | 0115 924 1100

www.bwbconsulting.com

Client

TRITAX SYMMETRY
A TRITAX BIG BOX COMPANY

Project Title

**HINCKLEY NATIONAL RAIL
FREIGHT INTERCHANGE**

Drawing Title

**HGV ROUTING
STRATEGY
ANPR CAMERA 5
LOCATION**

Drawn:	S. Carter	Reviewed:	A. Passmore
BWB Ref:	NTT2814	Date:	31.01.24
Scale@A1:	As Shown		

Drawing Status

PRELIMINARY

Project - Originator - Zone - Level - Type - Role - Number	Status	Rev
HRF-BWB-HSN-05-DR-CH-1250	S2	P01

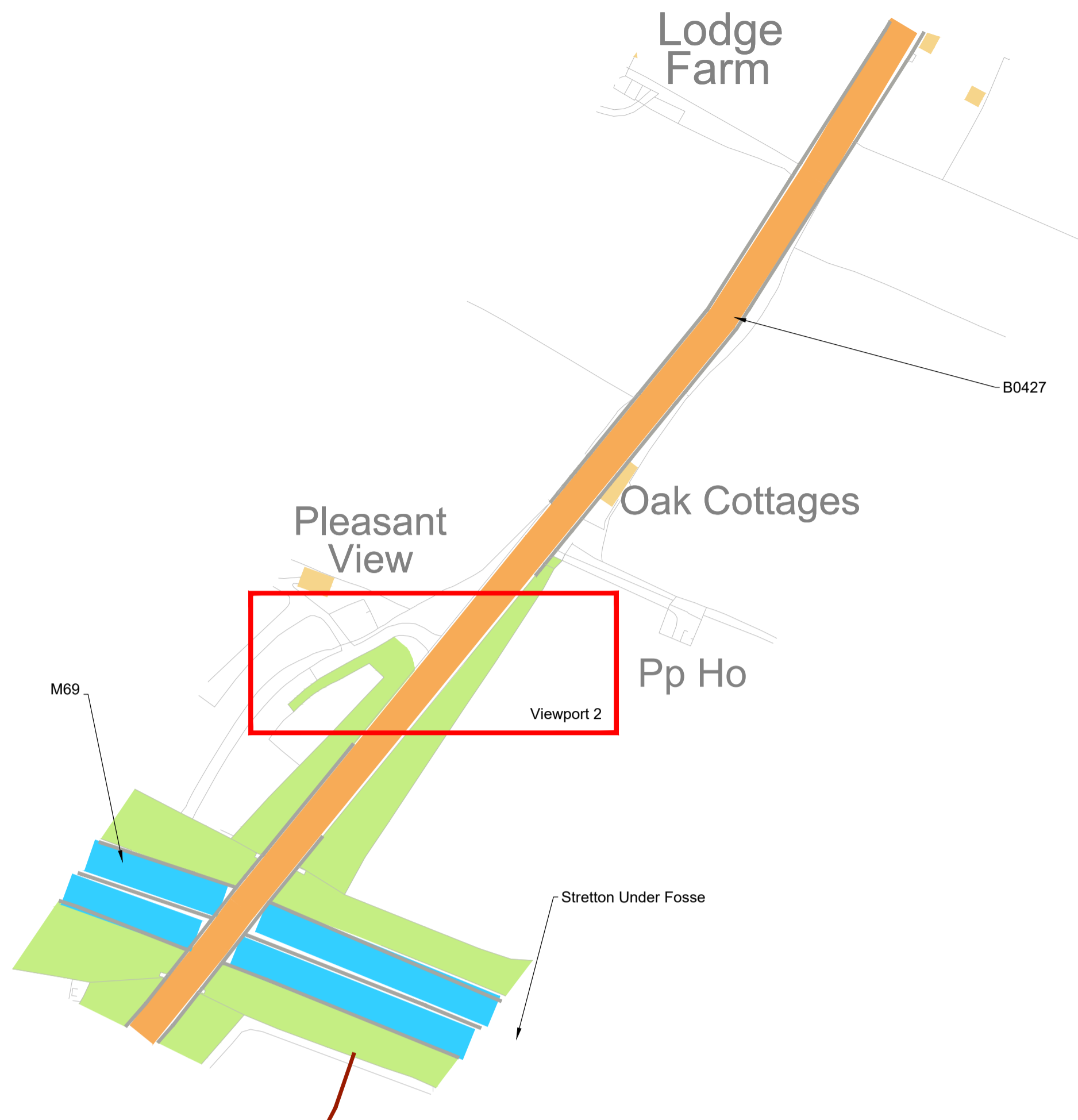

Viewport 1 - Scale 1:2000



Streetview Image of Approximate Location



Viewport 2 - Scale 1:200

Notes

1. Do not scale this drawing. All dimensions must be checked/ verified on site. If in doubt ask.
2. This drawing is to be read in conjunction with all relevant architects, engineers and specialists drawings and specifications.
3. All dimensions in millimetres unless noted otherwise. All levels in metres unless noted otherwise.
4. Any discrepancies noted on site are to be reported to the engineer immediately.
5. ANPR locations shown indicatively. Subject to detailed design, survey and approval by relevant highway authorities.

Legend

— Indicative WCC Highway Boundary

P02	20.02.24	Relocated Camera	SC	AP
P01	31.01.24	Preliminary Issue	SC	AP
Rev	Date	Details of issue / revision	Drw	Rev

Issues & Revisions

BWB
A CAF GROUP COMPANY

- Birmingham | 0121 233 3322
- Leeds | 0113 233 8000
- London | 020 7407 3879
- Manchester | 0161 233 4260
- Nottingham | 0115 924 1100

www.bwbconsulting.com

Client

TRITAX SYMMETRY
A TRITAX BIG BOX COMPANY

**HINCKLEY NATIONAL RAIL
FREIGHT INTERCHANGE**

**HGV ROUTING
STRATEGY
ANPR CAMERA 6
LOCATION**

Drawn:	S. Carter	Reviewed:	A. Passmore
BWB Ref:	NTT2814	Date:	20.02.24
Scale@A1:	As Shown	Status:	PRELIMINARY

Project - Originator - Zone - Level - Type - Role - Number	Status	Rev
HRF-BWB-HSN-06-DR-CH-1250	S2	P02



The Old Vicarage

Fox Close

MAIN ST

The Hayes

SMYTHE CL

Monks Kirby

BELL LANE

PPp Hto

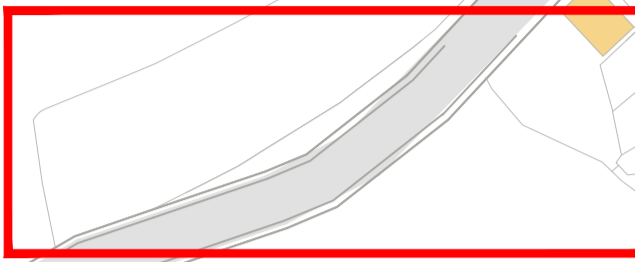

Viewport 2

B4027

Viewport 1 - Scale 1:2000



Streetview Image of Approximate Location

Approximate location of ANPR camera



B4027

Viewport 2 - Scale 1:200

Notes

1. Do not scale this drawing. All dimensions must be checked/ verified on site. If in doubt ask.
2. This drawing is to be read in conjunction with all relevant architects, engineers and specialists drawings and specifications.
3. All dimensions in millimetres unless noted otherwise. All levels in metres unless noted otherwise.
4. Any discrepancies noted on site are to be reported to the engineer immediately.
5. ANPR locations shown indicatively. Subject to detailed design, survey and approval by relevant highway authorities.

Legend

Indicative WCC Highway Boundary

P01	31.01.24	Preliminary Issue	SC	AP
Rev	Date	Details of issue / revision	Drw	Rev

Issues & Revisions

BWB
A CAF GROUP COMPANY

- Birmingham | 0121 233 3322
- Leeds | 0113 233 8000
- London | 020 7407 3879
- Manchester | 0161 233 4260
- Nottingham | 0115 924 1100

www.bwbconsulting.com

Client

TRITAX SYMMETRY
A TRITAX BIG BOX COMPANY

Project Title

HINCKLEY NATIONAL RAIL FREIGHT INTERCHANGE

Drawing Title

HGV ROUTEING STRATEGY ANPR CAMERA 7 LOCATION

Drawn:	S. Carter	Reviewed:	A. Passmore
BWB Ref:	NTT2814	Date:	31.01.24
Scale:	A1:	As Shown	

Drawing Status

PRELIMINARY

Project - Originator - Zone - Level - Type - Role - Number	Status	Rev
HRF-BWB-HSN-07-DR-CH-1250	S2	P01

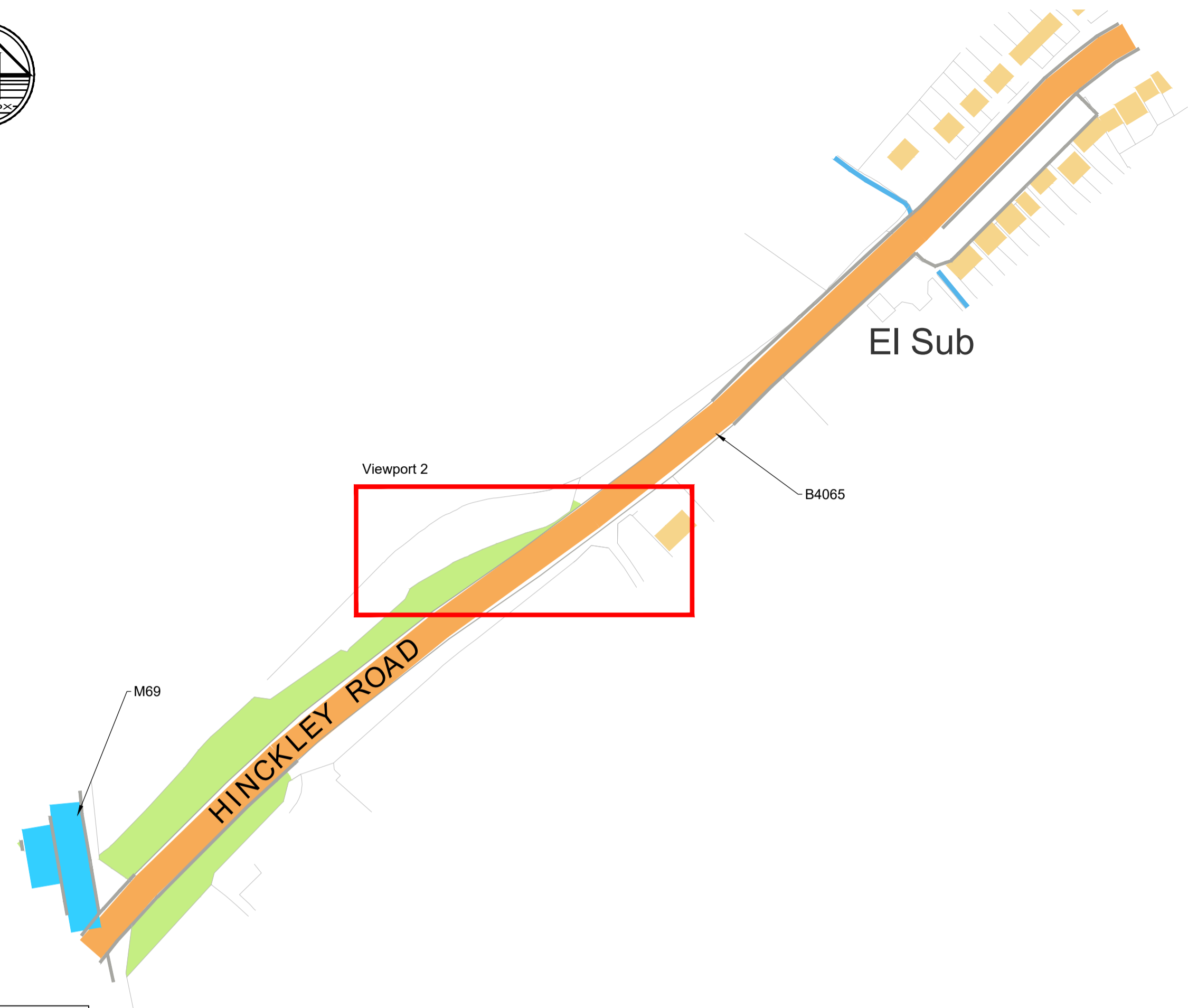

Viewport 1 - Scale 1:2000



Streetview Image of Approximate Location



Viewport 2 - Scale 1:200

Notes

1. Do not scale this drawing. All dimensions must be checked/ verified on site. If in doubt ask.
2. This drawing is to be read in conjunction with all relevant architects, engineers and specialists drawings and specifications.
3. All dimensions in millimetres unless noted otherwise. All levels in metres unless noted otherwise.
4. Any discrepancies noted on site are to be reported to the engineer immediately.
5. ANPR locations shown indicatively. Subject to detailed design, survey and approval by relevant highway authorities.

Legend

Indicative WCC Highway Boundary

P01	20.02.24	Preliminary Issue	SC	AP
Rev	Date	Details of issue / revision	Drw	Rev

Issues & Revisions

BWB
A CAF GROUP COMPANY

- Birmingham | 0121 233 3322
- Leeds | 0113 233 8000
- London | 020 7407 3879
- Manchester | 0161 233 4260
- Nottingham | 0115 924 1100

www.bwbconsulting.com

Client

TRITAX SYMMETRY
A TRITAX BIG BOX COMPANY

HINCKLEY NATIONAL RAIL FREIGHT INTERCHANGE

HGV ROUTING STRATEGY ANPR CAMERA 8 LOCATION

Drawn:	S. Carter	Reviewed:	A. Passmore
BWB Ref:	NTT2814	Date:	20.02.24
Scale@A1:	As Shown		

PRELIMINARY

Project - Originator - Zone - Level - Type - Role - Number	Status	Rev
HRF-BWB-HSN-08-DR-CH-1250	S2	P01

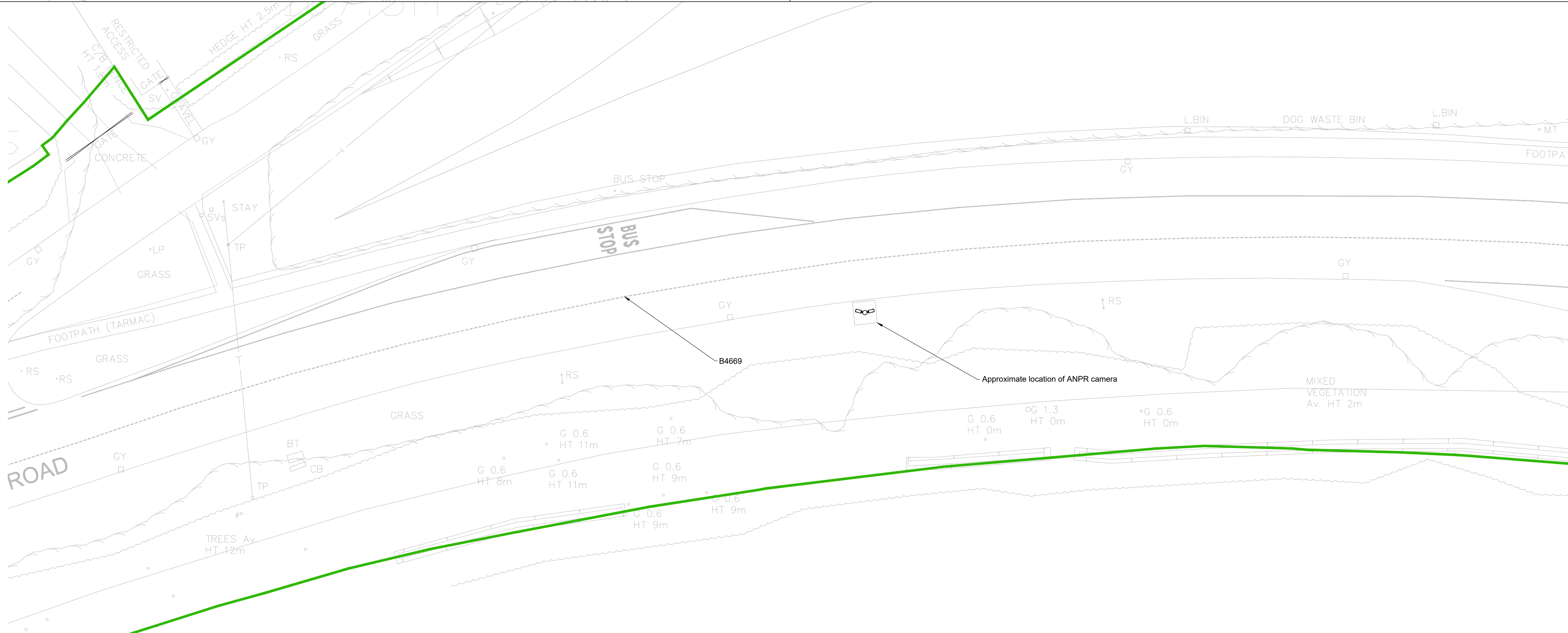
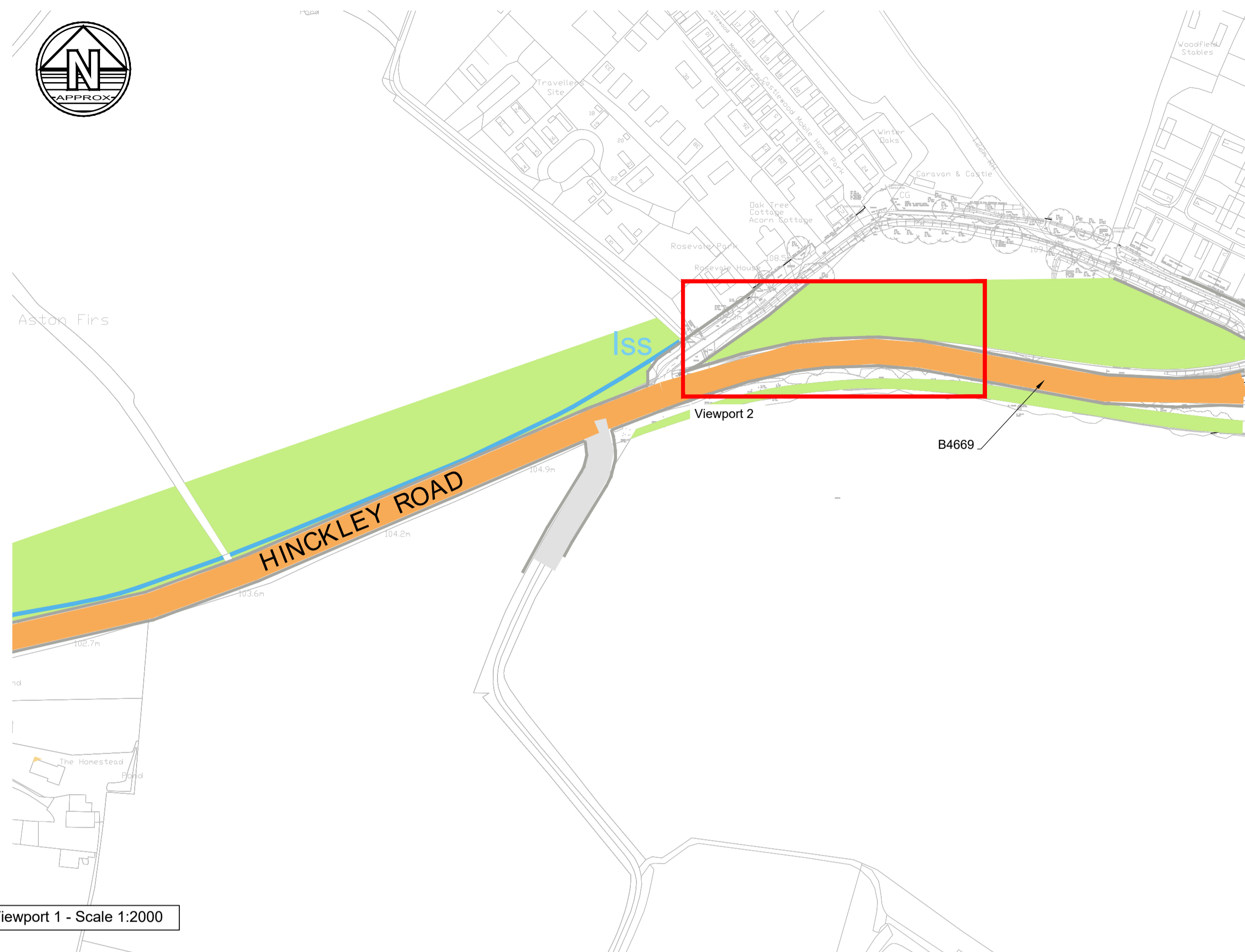

- Notes**
1. Do not scale this drawing. All dimensions must be checked/ verified on site. If in doubt ask.
 2. This drawing is to be read in conjunction with all relevant architects, engineers and specialists drawings and specifications.
 3. All dimensions in millimetres unless noted otherwise. All levels in metres unless noted otherwise.
 4. Any discrepancies noted on site are to be reported to the engineer immediately.
 5. ANPR locations shown indicatively. Subject to detailed design, survey and approval by relevant highway authorities.

Legend

— LCC Highway Boundary

P01	20.02.24	Preliminary Issue	SC	AP
Rev	Date	Details of issue / revision	Drw	Rev

Issues & Revisions

BWB
A CAF GROUP COMPANY

- Birmingham | 0121 233 3322
- Leeds | 0113 233 8000
- London | 020 7407 3879
- Manchester | 0161 233 4260
- Nottingham | 0115 924 1100

www.bwbconsulting.com

TRITAX SYMMETRY
A TRITAX BIG BOX COMPANY

Project Title
HINCKLEY NATIONAL RAIL FREIGHT INTERCHANGE

Drawing Title
HGV ROUTEING STRATEGY ANPR CAMERA 9 LOCATION

Drawn:	S. Carter	Reviewed:	A. Passmore
BWB Ref:	NTT2814	Date:	20.02.24
Scale@A1:	As Shown	Status:	PRELIMINARY
Project - Originator - Zone - Level - Type - Role - Number	HRF-BWB-HSN-09-DR-CH-1250	Status	S2
Rev	P01		

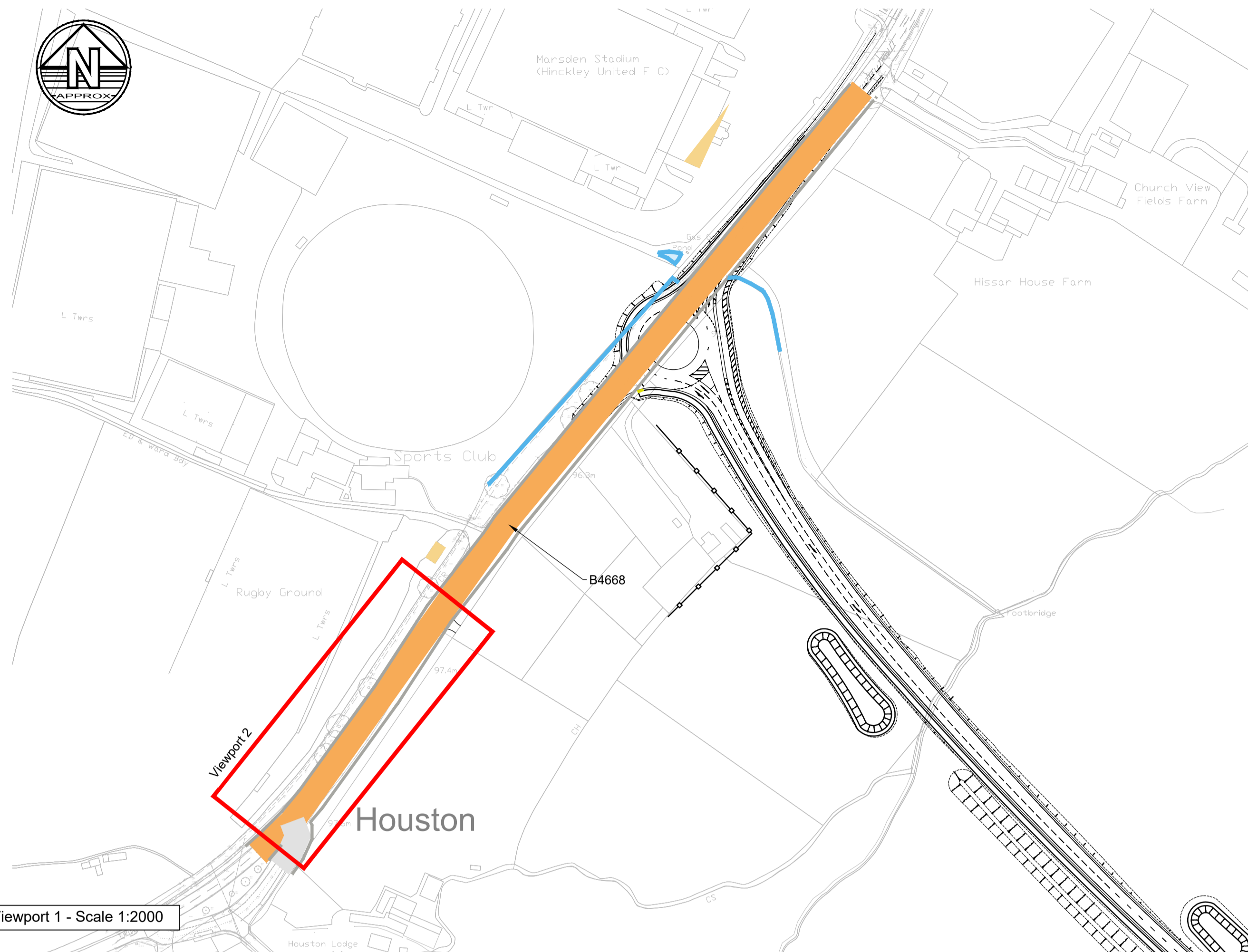

Viewport 1 - Scale 1:2000



Streetview Image of Approximate Location

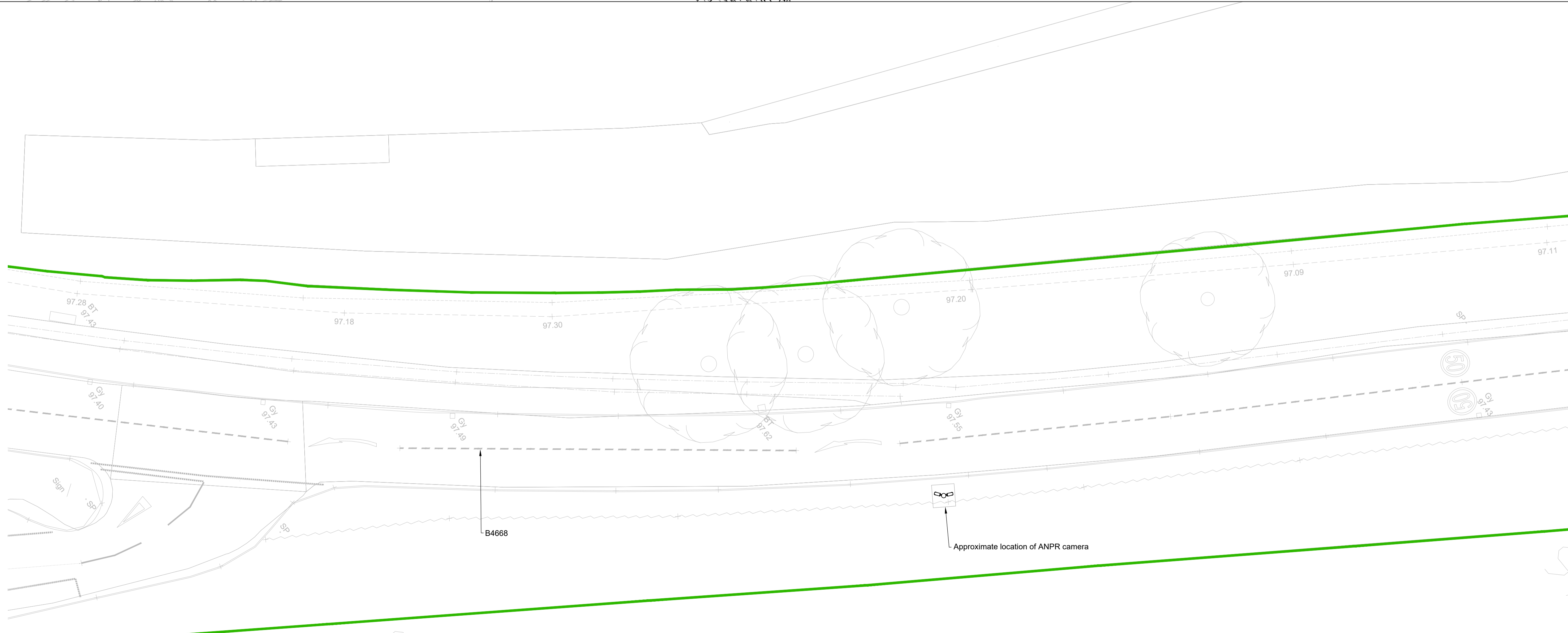

Viewport 2 - Scale 1:200

Notes

1. Do not scale this drawing. All dimensions must be checked/ verified on site. If in doubt ask.
2. This drawing is to be read in conjunction with all relevant architects, engineers and specialists drawings and specifications.
3. All dimensions in millimetres unless noted otherwise. All levels in metres unless noted otherwise.
4. Any discrepancies noted on site are to be reported to the engineer immediately.
5. ANPR locations shown indicatively. Subject to detailed design, survey and approval by relevant highway authorities.

Legend

— LCC Highway Boundary

P01	20.02.24	Preliminary Issue	SC	AP
Rev	Date	Details of issue / revision	Drw	Rev

Issues & Revisions

BWB
A CAF GROUP COMPANY

- Birmingham | 0121 233 3322
- Leeds | 0113 233 8000
- London | 020 7407 3879
- Manchester | 0161 233 4260
- Nottingham | 0115 924 1100

www.bwbconsulting.com

Client

TRITAX SYMMETRY
A TRITAX BIG BOX COMPANY

Project Title

HINCKLEY NATIONAL RAIL FREIGHT INTERCHANGE

Drawing Title

HGV ROUTING STRATEGY ANPR CAMERA 10 LOCATION

Drawn:	S. Carter	Reviewed:	A. Passmore
--------	-----------	-----------	-------------

BWB Ref:	NTT2814	Date:	20.02.24	Scale@A1:	As Shown
----------	---------	-------	----------	-----------	----------

Drawing Status

PRELIMINARY

Project - Originator - Zone - Level - Type - Role - Number	Status	Rev
------------------------------------------------------------	--------	-----

HRF-BWB-HSN-10-DR-CH-1250 S2 P01

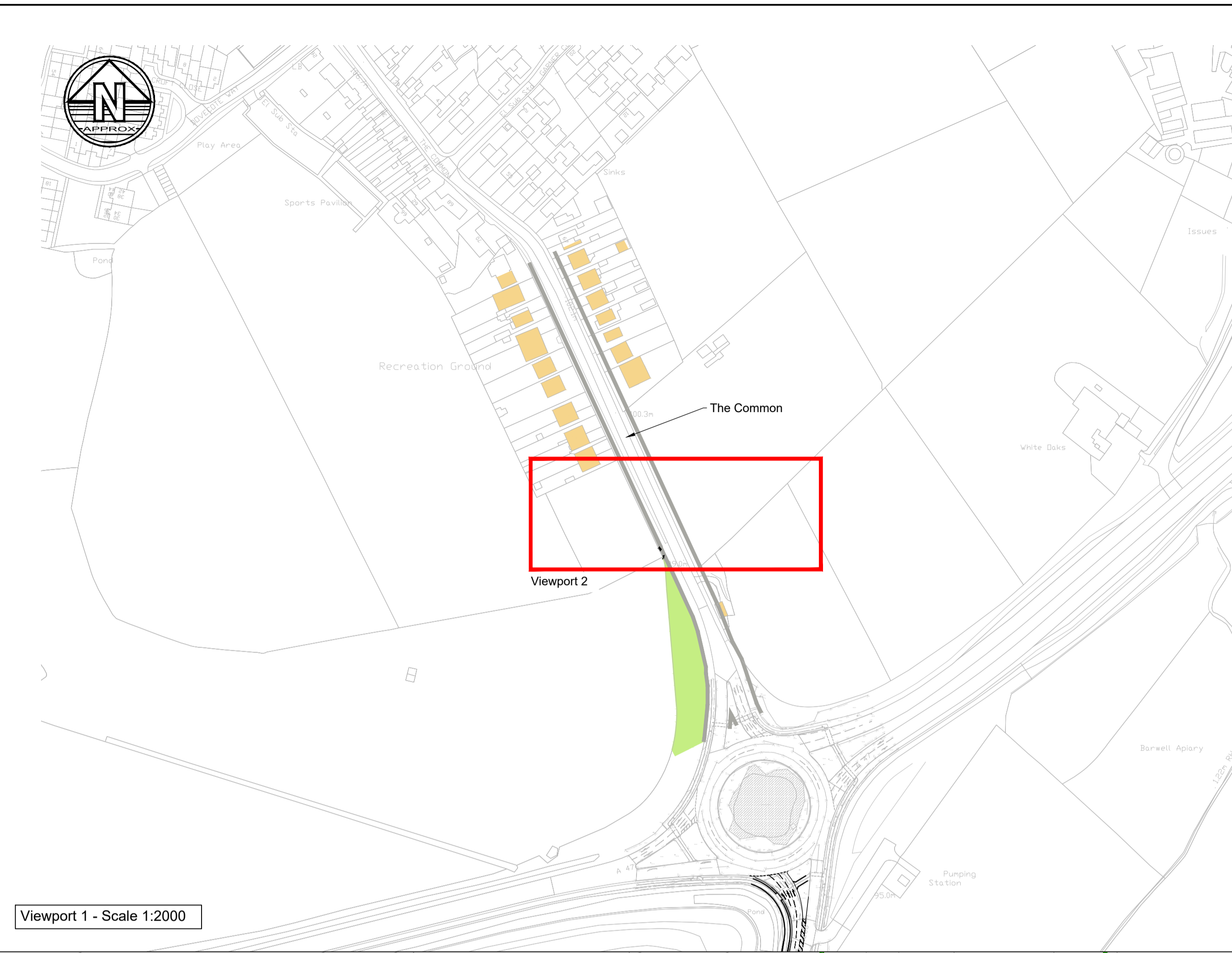

- Notes**
1. Do not scale this drawing. All dimensions must be checked/ verified on site. If in doubt ask.
 2. This drawing is to be read in conjunction with all relevant architects, engineers and specialists drawings and specifications.
 3. All dimensions in millimetres unless noted otherwise. All levels in metres unless noted otherwise.
 4. Any discrepancies noted on site are to be reported to the engineer immediately.
 5. ANPR locations shown indicatively. Subject to detailed design, survey and approval by relevant highway authorities.

Legend

- LCC Highway Boundary

P01	20.02.24	Preliminary Issue	SC	AP
Rev	Date	Details of issue / revision	Drw	Rev

Issues & Revisions

Birmingham | 0121 233 3322
 Leeds | 0113 233 8000
 London | 020 7407 3879
 Manchester | 0161 233 4260
 Nottingham | 0115 924 1100
www.bwbconsulting.com

Client

A TRITAX BIG BOX COMPANY

Project Title

HINCKLEY NATIONAL RAIL FREIGHT INTERCHANGE

Drawing Title

HGV ROUTING STRATEGY ANPR CAMERA 11 LOCATION

Drawn:	S. Carter	Reviewed:	A. Passmore
BWB Ref:	NTT2814	Date:	20.02.24
Scale@A1:	As Shown		

Drawing Status

PRELIMINARY

Project - Originator - Zone - Level - Type - Role - Number	Status	Rev
HRF-BWB-HSN-11-DR-CH-1250	S2	P01

Appendix 2 – Example Measures for additional works fund

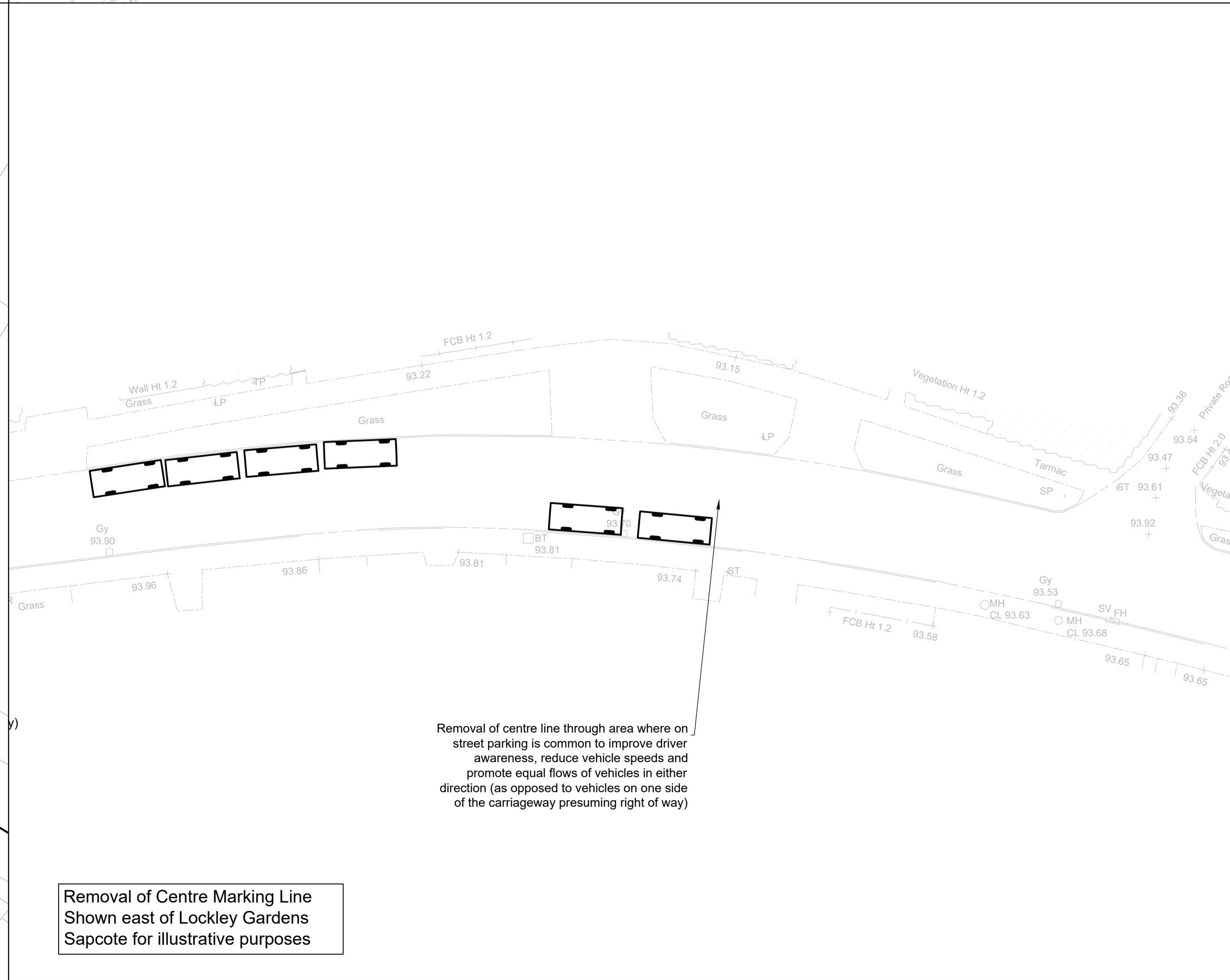
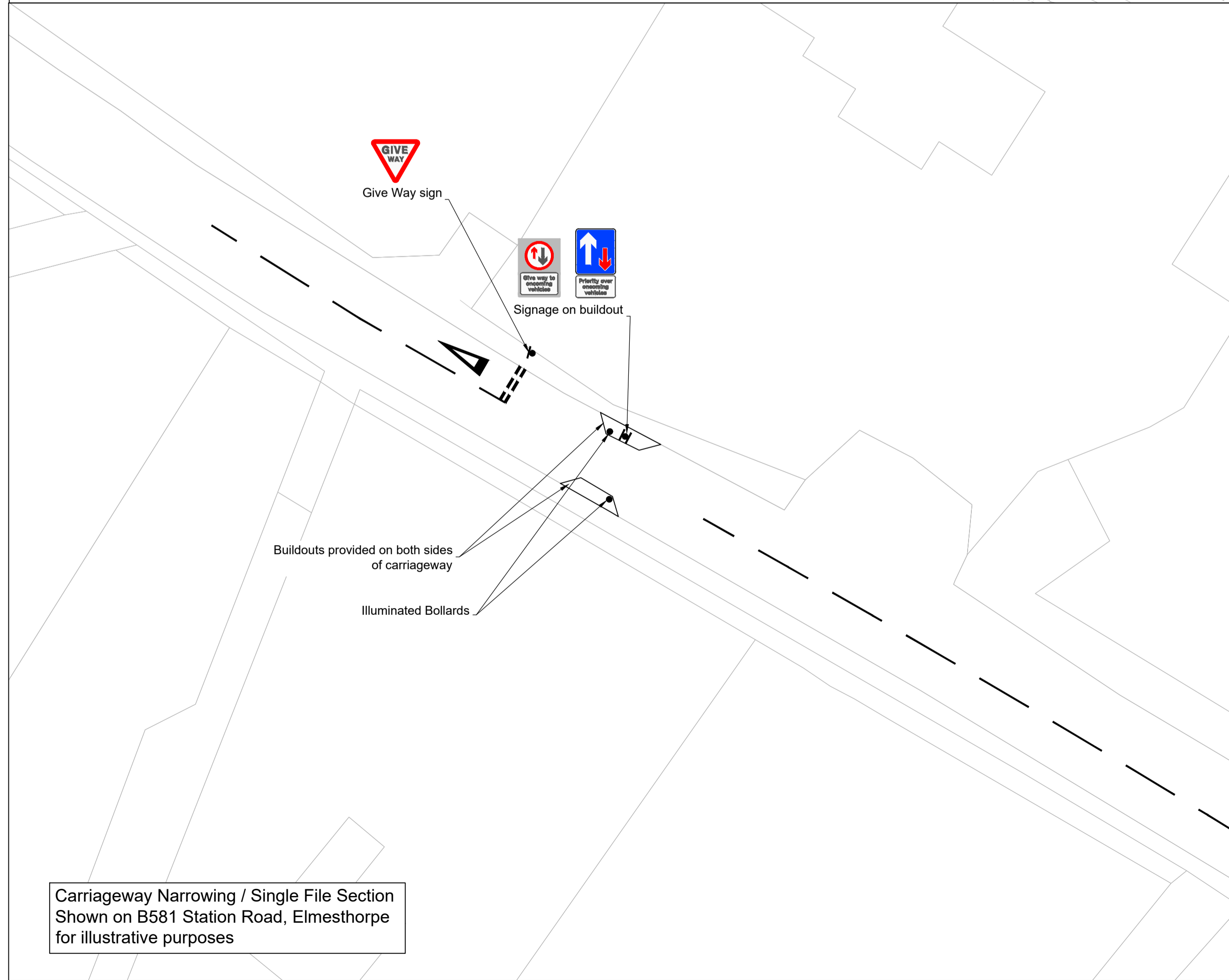
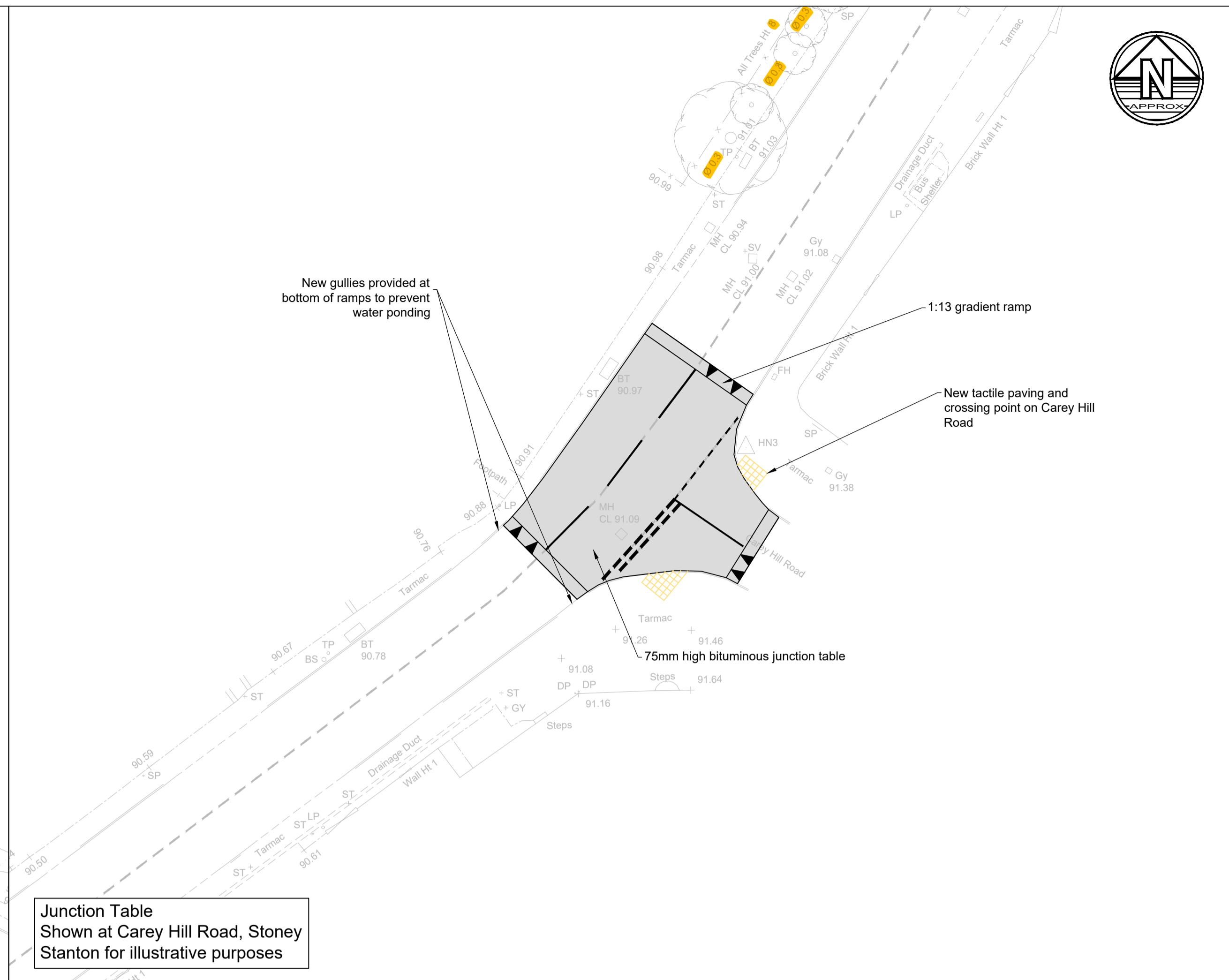
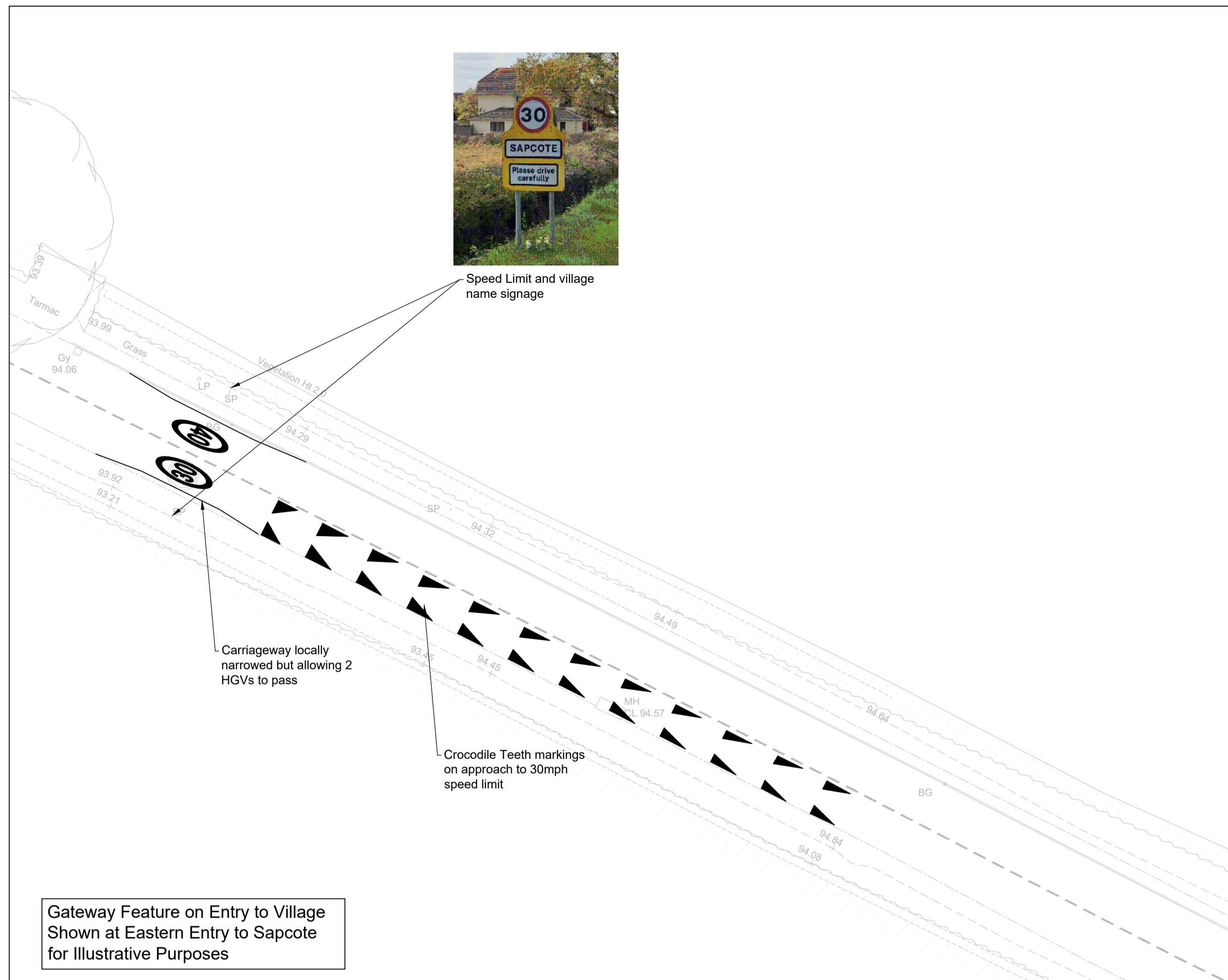

- Notes**
- Do not scale from this drawing. All dimensions must be checked/verified on site. If in doubt, ask.
 - This drawing is to be read in conjunction with all relevant architects, engineers and specialists drawings and specifications
 - All dimensions in metres unless noted otherwise. All levels in metres unless noted otherwise
 - Any discrepancies noted on site are to be reported to the engineer immediately
 - For further details on specific areas of works, see the relevant SHW series drawings and appendices
 - All works must be carried out to the requirements of the overseeing organisation.
- NOTE**
- The purpose of this drawing is to illustrate the types of interventions that could be implemented within villages around HNRFI.
- These are shown, for the purposes of this drawing, implemented in Sapcote, Stoney Stanton and Elmesthorpe but could be provided on any route where HNRFI HGVs are prohibited, as allowed for through the HGV Strategy Steering Group.
- Any measures are subject to identified need via the HGV Strategy Steering Group and agreement with the local highway authority.

P02	28.10.24	Locations Amended	SC	SRH
P01	09.10.24	Preliminary Issue	SC	SRH
Rev	Date	Details of issue / revision	Drw	Rev

Issues & Revisions

BWB
A CAF GROUP COMPANY

- Birmingham | 0121 233 3322
- Leeds | 0113 233 8000
- London | 020 7407 3879
- Manchester | 0161 233 4260
- Nottingham | 0115 924 1100
- www.bwbconsulting.com

Client

TRITAX SYMMETRY
A TRITAX BIG BOX COMPANY

Project Title

HINCKLEY NATIONAL RAIL FREIGHT INTERCHANGE

Drawing Title

POTENTIAL FURTHER MITIGATION MEASURES FOR HGV TRAFFIC

Drawn:	S Carter	Reviewed:	S. Hilditch
BWB Ref:	NTT2814	Date:	09.10.24
Scale@A1:	1:250	Status	Rev
PRELIMINARY			
Project - Originator - Zone - Level - Type - Role - Number	Status	Rev	
HRF-BWB-GEN-XX-SK-CH-SK183	S2	P02	